



Agenda for a meeting of the Bradford District Licensing Panel to be held on Wednesday, 4 August 2021 at 1.00 pm in the Banqueting Hall - City Hall, Bradford

Members of the Committee – Councillors

LABOUR	CONSERVATIVE
M Slater Hussain	Winnard

Notes:

- This agenda can be made available in Braille, large print or tape format on request by contacting the Agenda contact shown below.
- The taking of photographs, filming and sound recording of the meeting is allowed except if Councillors vote to exclude the public to discuss confidential matters covered by Schedule 12A of the Local Government Act 1972. Recording activity should be respectful to the conduct of the meeting and behaviour that disrupts the meeting (such as oral commentary) will not be permitted. Anyone attending the meeting who wishes to record or film the meeting's proceedings is advised to liaise with the Agenda Contact who will provide guidance and ensure that any necessary arrangements are in place. Those present who are invited to make spoken contributions to the meeting should be aware that they may be filmed or sound recorded.
- If any further information is required about any item on this agenda, please contact the officer named at the foot of that agenda item.
- On the day of the meeting you are encouraged to wear a suitable face covering (unless you are medically exempt) and adhere to social distancing. Staff will be at hand to advise accordingly.

From:

Parveen Akhtar

City Solicitor

Agenda Contact: Jane Lythgow/Jill Bell

Phone: 01274 434580/432270/434287

E-Mail: jane.lythgow@bradford.gov.uk

To:

A. PROCEDURAL ITEMS

1. DISCLOSURES OF INTEREST

(Members Code of Conduct - Part 4A of the Constitution)

To receive disclosures of interests from members and co-opted members on matters to be considered at the meeting. The disclosure must include the nature of the interest.

An interest must also be disclosed in the meeting when it becomes apparent to the member during the meeting.

Notes:

- (1) Members may remain in the meeting and take part fully in discussion and voting unless the interest is a disclosable pecuniary interest or an interest which the Member feels would call into question their compliance with the wider principles set out in the Code of Conduct. Disclosable pecuniary interests relate to the Member concerned or their spouse/partner.*
- (2) Members in arrears of Council Tax by more than two months must not vote in decisions on, or which might affect, budget calculations, and must disclose at the meeting that this restriction applies to them. A failure to comply with these requirements is a criminal offence under section 106 of the Local Government Finance Act 1992.*
- (3) Members are also welcome to disclose interests which are not disclosable pecuniary interests but which they consider should be made in the interest of clarity.*
- (4) Officers must disclose interests in accordance with Council Standing Order 44.*

2. INSPECTION OF REPORTS AND BACKGROUND PAPERS

(Access to Information Procedure Rules – Part 3B of the Constitution)

Reports and background papers for agenda items may be inspected by contacting the person shown after each agenda item. Certain reports and background papers may be restricted.

Any request to remove the restriction on a report or background paper should be made to the relevant Strategic Director or Assistant Director whose name is shown on the front page of the report.

If that request is refused, there is a right of appeal to this meeting.

Please contact the officer shown below in advance of the meeting if you wish to appeal.

(Jane Lythgow - 01274 432270)

B. BUSINESS ITEMS

3. APPLICATION FOR VARIATION - 24 GENERAL MARKET, 489-491 LITTLE HORTON LANE, BRADFORD BD5 9BY 1 - 42

The Interim Assistant Director Waste, Fleet and Transport Services will present a report (**Document “F”**) which outlines an application for the variation of a Premises Licence to extend permitted hours for the sale of alcohol for consumption off the premises.

Members are invited to consider the information and documents referred to in Document “F” and, after hearing interested parties, determine the related application.

(Melanie McGurk – 01274 431873)

THIS AGENDA AND ACCOMPANYING DOCUMENTS HAVE BEEN PRODUCED, WHEREVER POSSIBLE, ON RECYCLED PAPER

This page is intentionally left blank



Report of the Interim Assistant Director Waste, Fleet & Transport Services to the meeting of the Bradford Area Licensing Panel to be held on 4 August 2021.

F

Subject:

Application for variation of a premises licence for 24 General Market, 489-491 Little Horton Lane, Bradford, BD5 9BY.

Summary statement:

Application for variation to extend permitted hours for the sale of alcohol for consumption off the premises.

EQUALITY & DIVERSITY

The Council has to comply with the public sector equality duty in S.149 Equality Act 2010.

Susan Spink
Interim Assistant Director
Waste, Fleet & Transport Services

Report Contact: Melanie McGurk
Senior Licensing Officer
Phone: (01274) 431873
E-mail: melanie.mcgurk@bradford.gov.uk

Portfolio:

Neighbourhoods & Community Safety

Overview & Scrutiny Area:

Corporate

1. SUMMARY

The application is for variation to extend permitted hours for the sale of alcohol for consumption off the premises.

2. BACKGROUND

2.1 The applicant

Mr Taha Ali Said. A copy of the application is included at Appendix 1.

2.2 The Premises

24 General Market, 489-491 Little Horton Lane, Bradford, BD5 9BY.

2.3 Designated Premises Supervisor

Mr Taha Ali Said.

2.4 Current Licence

The premises currently hold a Premises Licence with the following permitted hours;

Supply of Alcohol for consumption off the premises

Monday to Sunday: 07.00 to 23.00

A copy of the premises licence is included at Appendix 2.

2.5 Application

The variation application has been submitted to extend permitted hours for the sale of alcohol for consumption off the premises.

Hours of licensable activities requested:

Supply of Alcohol for consumption off the premises

Monday to Sunday: 23.00 to 07.00

2.6 Steps proposed by the applicant to address the Licensing Objectives

a) Prevention of crime and disorder will be achieved by;

The premises shall install and maintain a comprehensive digital colour CCTV system. All public areas of the licensed premises, including all public entry and

exit points. The CCTV cameras shall continually record whilst the premises are open to the public and recording shall be kept available and unedited for a minimum of 28 days with the date and time stamping. A staff member who is conversant with the operation of the CCTV system shall be present on the premises at all times when they are open to the public and must be able to produce / download / burn CCTV images upon request by a police officer or an authorised officer of the licensing authority. Any footage must be in a format so it can be played back on a standard personal computer or standard DVD player. Where the recording is on a removable medium (i.e. compact disc, flash card etc.), a secure storage system to store those recording mediums shall be provided.

An incident log (which may be electronically recorded) shall be kept at the premises for at least six months, and made available on request to the Police or an authorised officer of the licensing authority, which will record the following incidents including pertinent details:

- (a) all crimes reported to the venue, or by the venue to the Police
- (b) all ejections of patrons
- (c) any incidents of disorder
- (d) any faults in the CCTV system
- (e) any visit by a relevant authority or emergency service

The Designated Premises Supervisor shall ensure that a written notice of authority is kept at the premises for all staff who sell alcohol. The notice shall be made available for inspection upon request of the police or an authorised officer of the licensing authority and all staff selling alcohol must be in possession of formal identification to enable to verify their identity against the notice.

- b) Public safety will be achieved by;

None.

- c) Prevention of public nuisance will be achieved by;

Notices will be displayed to ask customers to respect the neighbours and leave quietly. Internal notices will be displayed to ask customers not to gather outside the premise after 10pm at night.

The premises licence holder shall ensure that the external areas of the premises are kept clear of litter and refuse.

- d) Protection of children from harm will be achieved by;

Legal notices will be displayed to warn minors ID checks are always used when the age of the customer is in doubt. All staff will be trained in challenge 25 procedures. Proof of training will be kept on the premises and updated every 6 months. A record of any incidents will be made and kept on site for inspection.

An appropriate proof of age policy, incorporating the principles of the "Challenge 25" Campaign be implemented. incorporating measures to ensure that any patron wishing to purchase alcohol who may reasonably appear to be under 25 years of age are asked to prove that they are at least 18 years old by displaying

evidence of their identity and age in the form of a valid UK passport, new style driving licence displaying their photograph or PASS identification.

No licensable activities shall take place at the premises unless or until a CCTV system (with satisfactory internal and external coverage) of a standard acceptable to and to the written satisfaction of West Yorkshire Police and the Licensing Authority has been installed at the premises. The approved CCTV shall be maintained in good working order and used at all times the premises remain open to the public for licensable activities. Any CCTV footage shall be kept for at least 28 days and be available to the Licensing Authority or a Responsible Authority on request.

e) General – all four licensing objectives

Please see above.

2.7 Relevant Representations Received

Responsible Authorities

Environmental Health

A representation has been received from the Environmental Health Department which has seen an increase in complaints about noise and general disturbance from premises that are open 24 hours a day. The complaints tend to be about noise and disturbance caused by people gathering outside the premises and also about noise from vehicles pulling up outside or near to the premises with their engines running and loud music playing.

The premises are near to a number of residential properties and the Department understands that a number of elderly residents have contacted a Ward Councillor to complain about noise and anti-social behaviour connected to the premises.

The officer is of the opinion that granting a licence for the sale of alcohol 24 hours a day will not benefit the situation and therefore does not support the application.

The representation is attached at Appendix 3.

Individual, Body or Business

A representation has been received from a Ward Councillor, who has received complaints from elderly residents who live nearby regarding noise and anti-social behaviour and light pollution. The Councillor also has concerns regarding young people congregating outside the shop, mainly to use a punch machine.

The representation is attached at Appendix 4.

3. OTHER CONSIDERATIONS

Legal Appraisal

- 3.1** The Licensing Act 2003 requires the Council to carry out its various licensing functions so as to promote the following four licensing objectives:
- a) the prevention of crime and disorder
 - b) public safety
 - c) the prevention of public nuisance
 - d) the protection of children from harm
- 3.2** The Council must also have regard to the guidance issued by the Home Office under Section 182 of the Licensing Act 2003. Regard must also be taken of the Council's statement of Licensing Policy for the District.
- 3.3** Where it is decided it is necessary to depart from the statutory guidance or the Licensing Policy on the merits of a particular case; then special reasons justifying this must be given that can be sustained.
- 3.4** Only "relevant representations" can be taken into account. In order to be "relevant" a representation must fairly relate to achieving a licensing objective. If it does not, it must be discounted.
- 3.5** Any licensing conditions that Members may propose attaching must also relate to achieving one of the licensing objectives; be tailored to the actual premises and style of licensable activity; must be reasonably achievable by the applicant and in his/her control.

Statement of Policy Issues

- 3.6** The following parts of the Licensing Policy are of particular importance; Part 4 (prevention of crime and disorder), Part 6 (prevention of public nuisance) and Part 7 (protection of children from harm).
- 3.7** The Annexes to the Policy sets out various types of model condition that could be considered.

4. FINANCIAL & RESOURCE APPRAISAL

There are no apparent finance or resource implications.

5. RISK MANAGEMENT AND GOVERNANCE ISSUES

There are no apparent risk management and governance implications.

6. LEGAL APPRAISAL

Referred to in part 3 of this report.

7. OTHER IMPLICATIONS

7.1 SUSTAINABILITY IMPLICATIONS

There are no apparent sustainability implications.

7.2 GREENHOUSE GAS EMISSIONS IMPACTS

There are no apparent implications.

7.3 COMMUNITY SAFETY IMPLICATIONS

When determining the application the Licensing Authority is required to pay due regard to the licensing objectives referred to in 3.1 of this report.

7.4 HUMAN RIGHTS ACT

The following rights are applicable:

Article 1 First Protocol to the Convention – Right to peaceful enjoyment of possessions subject to the state's right to control the use of property in accordance with the general interest. The Council's powers set out in the recommendations fall within the states right. A fair balance must be struck between public safety and the applicant's rights.

Article 6 – A procedural right to a fair hearing. As refusal of the application is an option, adherence to the Panels' usual procedure of affording a hearing to the applicant is very important. The applicant should also be able to examine the requirements of the fire authority. If the decision is to refuse then reasons should be given.

7.5 TRADE UNION

Not applicable.

7.6 WARD IMPLICATIONS

Ward Councillors have been notified of receipt of the application.

7.7 IMPLICATIONS FOR CORPORATE PARENTING

There are no apparent implications.

7.8 ISSUES ARISING FROM PRIVACY IMPACT ASSESSMENT

There are no apparent implications.

8. NOT FOR PUBLICATION DOCUMENTS

None.

9. OPTIONS

9.1 Members may:

- (a) Vary a premises licence as applied for subject to any mandatory conditions and the precautions specified in the operating schedule submitted.
- (b) Vary a premises licence in whole or in part subject to such additional conditions relating to achievement of the licensing objectives as members think fit; or
- (c) Refuse to vary the premises licence.

9.2 Should the applicant or any other party to the hearing feel aggrieved at any decision with regard to the licence or to any conditions or restrictions attached by Members they may appeal to the Magistrates Court.

10. RECOMMENDATIONS

Members are invited to consider the information and documents referred to in this report and, after hearing individuals, bodies or businesses, determine the related application(s):.

11. APPENDICES

1. Application form received 11 June 2021. In the interests of economy this document has been sent to Members of the Panel only. A public inspection copy is available in Committee Secretariat, Room 112, City Hall, Bradford or on www.bradford.gov.uk).
2. Copy of current premises licence.
3. Representation from Environmental Health.
4. Representation from Individual, Body or Business.

12. BACKGROUND DOCUMENTS

Application form, plan etc.

This page is intentionally left blank

Application to vary a premises licence under the Licensing Act 2003**PLEASE READ THE FOLLOWING INSTRUCTIONS FIRST**

Before completing this form please read the guidance notes at the end of the form. If you are completing this form by hand please write legibly in block capitals. In all cases ensure that your answers are inside the boxes and written in black ink. Use additional sheets if necessary.

You may wish to keep a copy of the completed form for your records.

I/We Taha Said

(Insert name(s) of applicant)

being the premises licence holder, apply to vary a premises licence under section 34 of the Licensing Act 2003 for the premises described in Part 1 below

Premises licence number 217668
--

Part 1 – Premises Details

Postal address of premises or, if none, ordnance survey map reference or description 24 General Market 489-491 Little Horton Lane			
Post town	Bradford	Postcode	BD5 9BY

Telephone number at premises (if any)	
Non-domestic rateable value of premises	£2500

Part 2 – Applicant details

Daytime contact telephone number			
E-mail address (optional)			
Current postal address if different from premises address			
Post town		Postcode	

Part 3 - Variation

Please tick as appropriate

Do you want the proposed variation to have effect as soon as possible? Yes No

If not, from what date do you want the variation to take effect?

DD	MM	YYYY

Do you want the proposed variation to have effect in relation to the introduction of the late night levy? (Please see guidance note 1) Yes No

Please describe briefly the nature of the proposed variation (Please see guidance note 2)

The variation is to change the hours for the retail sale of alcohol

If your proposed variation would mean that 5,000 or more people are expected to attend the premises at any one time, please state the number expected to attend:

Part 4 Operating Schedule

Please complete those parts of the Operating Schedule below which would be subject to change if this application to vary is successful.

- | Provision of regulated entertainment (Please see guidance note 3) | Please tick all that apply |
|---|-----------------------------------|
| a) plays (if ticking yes, fill in box A) | <input type="checkbox"/> |
| b) films (if ticking yes, fill in box B) | <input type="checkbox"/> |
| c) indoor sporting events (if ticking yes, fill in box C) | <input type="checkbox"/> |
| d) boxing or wrestling entertainment (if ticking yes, fill in box D) | <input type="checkbox"/> |
| e) live music (if ticking yes, fill in box E) | <input type="checkbox"/> |
| f) recorded music (if ticking yes, fill in box F) | <input type="checkbox"/> |
| g) performances of dance (if ticking yes, fill in box G) | <input type="checkbox"/> |
| h) anything of a similar description to that falling within (e), (f) or (g) (if ticking yes, fill in box H) | <input type="checkbox"/> |

Provision of late night refreshment (if ticking yes, fill in box I)

Supply of alcohol (if ticking yes, fill in box J)

In all cases complete boxes K, L and M

A

Plays Standard days and timings (please read guidance note 8)			<u>Will the performance of a play take place indoors or outdoors or both – please tick</u> (please read guidance note 4)	Indoors	<input type="checkbox"/>			
				Outdoors	<input type="checkbox"/>			
				Both	<input type="checkbox"/>			
Day	Start	Finish	<u>Please give further details here</u> (please read guidance note 5)					
Mon								
Tue								
Wed						<u>State any seasonal variations for performing plays</u> (please read guidance note 6)		
Thur								
Fri								
Sat						<u>Non standard timings. Where you intend to use the premises for the performance of plays at different times to those listed in the column on the left, please list</u> (please read guidance note 7)		
Sun								

B

Films Standard days and timings (please read guidance note 8)			<u>Will the exhibition of films take place indoors or outdoors or both – please tick</u> (please read guidance note 4)	Indoors	<input type="checkbox"/>
				Outdoors	<input type="checkbox"/>
Day	Start	Finish		Both	<input type="checkbox"/>
Mon			<u>Please give further details here</u> (please read guidance note 5)		
Tue					
Wed			<u>State any seasonal variations for the exhibition of films</u> (please read guidance note 6)		
Thur					
Fri			<u>Non standard timings. Where you intend to use the premises for the exhibition of films at different times to those listed in the column on the left, please list</u> (please read guidance note 7)		
Sat					
Sun					

C

Indoor sporting events Standard days and timings (please read guidance note 8)			<u>Please give further details</u> (please read guidance note 5)
Day	Start	Finish	
Mon			
Tue			<u>State any seasonal variations for indoor sporting events</u> (please read guidance note 6)
Wed			
Thur			<u>Non standard timings. Where you intend to use the premises for indoor sporting events at different times to those listed in the column on the left, please list</u> (please read guidance note 7)
Fri			
Sat			
Sun			

D

Boxing or wrestling entertainments Standard days and timings (please read guidance note 8)			<u>Will the boxing or wrestling entertainment take place indoors or outdoors or both – please tick</u> (please read guidance note 4)	Indoors	<input type="checkbox"/>			
				Outdoors	<input type="checkbox"/>			
				Both	<input type="checkbox"/>			
Day	Start	Finish	<u>Please give further details here</u> (please read guidance note 5)					
Mon								
Tue								
Wed						<u>State any seasonal variations for boxing or wrestling entertainment</u> (please read guidance note 6)		
Thur								
Fri								
Sat						<u>Non standard timings. Where you intend to use the premises for boxing or wrestling entertainment at different times to those listed in the column on the left, please list</u> (please read guidance note 7)		
Sun								

E

Live music Standard days and timings (please read guidance note 8)			<u>Will the performance of live music take place indoors or outdoors or both – please tick</u> (please read guidance note 4)	Indoors	<input type="checkbox"/>
				Outdoors	<input type="checkbox"/>
				Both	<input type="checkbox"/>
Day	Start	Finish			
Mon			<u>Please give further details here</u> (please read guidance note 5)		
Tue					
Wed			<u>State any seasonal variations for the performance of live music</u> (please read guidance note 6)		
Thur					
Fri			<u>Non standard timings. Where you intend to use the premises for the performance of live music at different times to those listed in the column on the left, please list</u> (please read guidance note 7)		
Sat					
Sun					

F

Recorded music Standard days and timings (please read guidance note 8)			<u>Will the playing of recorded music take place indoors or outdoors or both – please tick</u> (please read guidance note 4)	Indoors	<input type="checkbox"/>			
				Outdoors	<input type="checkbox"/>			
				Both	<input type="checkbox"/>			
Day	Start	Finish	<u>Please give further details here</u> (please read guidance note 5)					
Mon								
Tue								
Wed						<u>State any seasonal variations for the playing of recorded music</u> (please read guidance note 6)		
Thur								
Fri						<u>Non standard timings. Where you intend to use the premises for the playing of recorded music at different times to those listed in the column on the left, please list</u> (please read guidance note 7)		
Sat								
Sun								

G

Performances of dance Standard days and timings (please read guidance note 8)			<u>Will the performance of dance take place indoors or outdoors or both – please tick</u> (please read guidance note 4)	Indoors	<input type="checkbox"/>			
				Outdoors	<input type="checkbox"/>			
				Both	<input type="checkbox"/>			
Day	Start	Finish	<u>Please give further details here</u> (please read guidance note 5)					
Mon								
Tue								
Wed						<u>State any seasonal variations for the performance of dance</u> (please read guidance note 6)		
Thur								
Fri								
Sat						<u>Non standard timings. Where you intend to use the premises for the performance of dance at different times to those listed in the column on the left, please list</u> (please read guidance note 7)		
Sun								

H

Anything of a similar description to that falling within (e), (f) or (g) Standard days and timings (please read guidance note 8)			Please give a description of the type of entertainment you will be providing		
Day	Start	Finish	<u>Will this entertainment take place indoors or outdoors or both – please tick</u> (please read guidance note 4)	Indoors	<input type="checkbox"/>
Mon				Outdoors	<input type="checkbox"/>
				Both	<input type="checkbox"/>
Tue			<u>Please give further details here</u> (please read guidance note 5)		
Wed					
Thur			<u>State any seasonal variations for entertainment of a similar description to that falling within (e), (f) or (g)</u> (please read guidance note 6)		
Fri					
Sat			<u>Non standard timings. Where you intend to use the premises for the entertainment of a similar description to that falling within (e), (f) or (g) at different times to those listed in the column on the left, please list</u> (please read guidance note 7)		
Sun					

I

Late night refreshment Standard days and timings (please read guidance note 8)			<u>Will the provision of late night refreshment take place indoors or outdoors or both – please tick</u> (please read guidance note 4)	Indoors	<input type="checkbox"/>			
				Outdoors	<input type="checkbox"/>			
				Both	<input type="checkbox"/>			
Day	Start	Finish	<u>Please give further details here</u> (please read guidance note 5)					
Mon								
Tue								
Wed						<u>State any seasonal variations for the provision of late night refreshment</u> (please read guidance note 6)		
Thur								
Fri								
Sat						<u>Non standard timings. Where you intend to use the premises for the provision of late night refreshment at different times, to those listed in the column on the left, please list</u> (please read guidance note 7)		
Sun								

J

Supply of alcohol Standard days and timings (please read guidance note 8)			Will the supply of alcohol be for consumption – please tick (please read guidance note 9)	On the premises	<input type="checkbox"/>			
				Off the premises	<input checked="" type="checkbox"/>			
				Both	<input type="checkbox"/>			
Day	Start	Finish	<u>State any seasonal variations for the supply of alcohol</u> (please read guidance note 6)					
Mon	00.00	23.59						
Tue	00.00	23.59						
Wed	00.00	23.59						
Thur	00.00	23.59				<u>Non-standard timings. Where you intend to use the premises for the supply of alcohol at different times to those listed in the column on the left, please list</u> (please read guidance note 7)		
Fri	00.00	23.59						
Sat	00.00	23.59						
Sun	00.00	23.59						

K

<p>Please highlight any adult entertainment or services, activities, other entertainment or matters ancillary to the use of the premises that may give rise to concern in respect of children (please read guidance note 10).</p>
--

L

Hours premises are open to the public Standard days and timings (please read guidance note 8)			<u>State any seasonal variations</u> (please read guidance note 6)
Day	Start	Finish	
Mon	00.00	00.59	
Tue	00.00	00.59	
Wed	00.00	00.59	
			<u>Non standard timings. Where you intend the premises to be open to the public at different times from those listed in the column on the left, please list</u> (please read guidance note 7)
Thur	00.00	00.59	
Fri	00.00	00.59	
Sat	00.00	00.59	
Sun	00.00	00.59	

Please identify those conditions currently imposed on the licence which you believe could be removed as a consequence of the proposed variation you are seeking.

The current terminal hour for sale of Alcohol by retail would be removed and replaced with the new terminal hour

Please tick as appropriate

- I have enclosed the premises licence
- I have enclosed the relevant part of the premises licence

If you have not ticked one of these boxes, please fill in reasons for not including the licence or part of it below

Reasons why I have not enclosed the premises licence or relevant part of premises licence.

M Describe any additional steps you intend to take to promote the four licensing objectives as a result of the proposed variation:

a) General – all four licensing objectives (b, c, d and e) (please read guidance note 11)

Please see below

b) The prevention of crime and disorder

The premises shall install and maintain a comprehensive digital colour CCTV system. All public areas of the licensed premises, including all public entry and exit points. The CCTV cameras shall continually record whilst the premises are open to the public and recording shall be kept available and unedited for a minimum of 28 days with the date and time stamping. A staff member who is conversant with the operation of the CCTV system shall be present on the premises at all times when they are open to the public and must be able to produce / download / burn CCTV images upon request by a police officer or an authorised officer of the licensing authority. Any footage must be in a format so it can be played back on a standard personal computer or standard DVD player. Where the recording is on a removable medium (i.e. compact disc, flash card etc.), a secure storage system to store those recording mediums shall be provided.

An incident log (which may be electronically recorded) shall be kept at the premises for at least six months, and made available on request to the Police or an authorised officer of the licensing authority, which will record the following incidents including pertinent details:

- (a) all crimes reported to the venue, or by the venue to the Police
- (b) all ejections of patrons
- (c) any incidents of disorder
- (d) any faults in the CCTV system
- (e) any visit by a relevant authority or emergency service

The Designated Premises Supervisor shall ensure that a written notice of authority is kept at the premises for all staff who sell alcohol. The notice shall be made available for inspection upon request of the police or an authorised officer of the licensing authority and all staff selling alcohol must be in possession of formal identification to enable to verify their identity against the notice.

c) Public safety

None

d) The prevention of public nuisance

Notices will be displayed to ask customers to respect the neighbours and leave quietly. Internal notices will be displayed to ask customers not to gather outside the premise after 10pm at night.
The premises licence holder shall ensure that the external areas of the premises are kept clear of litter and refuse

e) The protection of children from harm

Legal notices will be displayed to warn minors ID checks are always used when the age of the customer is in doubt. All staff will be trained in challenge 25 procedures. Proof of training will be kept on the premises and updated every 6 months. A record of any incidents will be made and kept on site for inspection.
An appropriate proof of age policy, incorporating the principles of the "Challenge 25" Campaign be implemented.
incorporating measures to ensure that any patron wishing to purchase alcohol who may reasonably appear to be under 25 years of age are asked to prove that they are at least 18 years old by displaying evidence of their identity and age in the form of a valid UK passport, new style driving licence displaying their photograph or PASS identification.
No licensable activities shall take place at the premises unless or until a CCTV system (with satisfactory internal and external coverage) of a standard acceptable to and to the written satisfaction of West Yorkshire Police and the Licensing Authority has been installed at the premises. The approved CCTV shall be maintained in good working order and used at all times the premises remain open to the public for licensable activities. Any CCTV footage shall be kept for at least 28 days and be available to the Licensing Authority or a Responsible Authority on request.

Checklist:

Please tick to indicate agreement

- I have made or enclosed payment of the fee; or
- I have not made or enclosed payment of the fee because this application has been made in relation to the introduction of the late night levy.
- I have sent copies of this application and the plan to responsible authorities and others where applicable.
- I understand that I must now advertise my application.
- I have enclosed the premises licence or relevant part of it or explanation.
- I understand that if I do not comply with the above requirements my application will be rejected.

IT IS AN OFFENCE, UNDER SECTION 158 OF THE LICENSING ACT 2003, TO MAKE A FALSE STATEMENT IN OR IN CONNECTION WITH THIS APPLICATION. THOSE WHO MAKE A FALSE STATEMENT MAY BE LIABLE ON SUMMARY CONVICTION TO A FINE OF ANY AMOUNT.

Part 5 – Signatures (please read guidance note 12)

Signature of applicant (the current premises licence holder) or applicant's solicitor or other duly authorised agent (please read guidance note 13). If signing on behalf of the applicant, please state in what capacity.

Signature	
Date	08/06/2021
Capacity	Agent for applicant

Where the premises licence is jointly held, signature of 2nd applicant (the current premises licence holder) or 2nd applicant's solicitor or other authorised agent (please read guidance note 14). If signing on behalf of the applicant, please state in what capacity.

Signature	
Date	
Capacity	

Contact name (where not previously given) and address for correspondence associated with this application (please read guidance note 15)			
Post town		Post code	
Telephone number (if any)			
If you would prefer us to correspond with you by e-mail, your e-mail address (optional)			

Notes for Guidance

This application cannot be used to vary the licence so as to extend the period for which the licence has effect or to vary substantially the premises to which it relates. If you wish to make that type of change to the premises licence, you should make a new premises licence application under section 17 of the Licensing Act 2003.

1. You do not have to pay a fee if the only purpose of the variation for which you are applying is to avoid becoming liable for the late night levy
2. Describe the premises. For example, the type of premises, its general situation and layout and any other information which could be relevant to the licensing objectives. Where your application includes off-supplies of alcohol and you intend to provide a place of consumption of these off-supplies of alcohol, you must include a description of where the place will be and its proximity to the premises.
3. In terms of specific regulated entertainments please note that:

Licensing Act 2003 - Premises Licence
Licence No: 217668

Date Issued: 31 March 2021

Part 1 - Premises Details

POSTAL ADDRESS OF PREMISES, OR IF NONE, ORDNANCE SURVEY MAP REFERENCE OR DESCRIPTION

24 General Market
489-491 Little Horton Lane, Bradford, BD5 9BY

WHERE THE LICENCE IS TIME LIMITED THE DATES

Not applicable

DATE FIRST GRANTED - ANNUAL FEE DATE

Licensing Act 2003 Fees Regulations 2005

17 December 2020

LICENSABLE ACTIVITIES AUTHORISED BY THE LICENCE

The Supply of Alcohol

THE TIMES THE LICENCE AUTHORISES THE CARRYING OUT OF LICENSABLE ACTIVITIES

The Supply of Alcohol	Mon 07:00-23:00
	Tue 07:00-23:00
	Wed 07:00-23:00
	Thu 07:00-23:00
	Fri 07:00-23:00
	Sat 07:00-23:00
	Sun 07:00-23:00

THE OPENING HOURS OF THE PREMISES

WHERE THE LICENCE AUTHORISES SUPPLY OF ALCOHOL WHETHER THIS IS ON AND/OR OFF SUPPLIES

The Supply of Alcohol Off Premises

Part 2

NAME, (REGISTERED) ADDRESS, TELEPHONE NUMBER AND EMAIL (WHERE RELEVANT) OF HOLDER OF PREMISES LICENCE

Mr Taha Ali Said
489-491 Little Horton Lane, Bradford, BD5 9BY

REGISTERED NUMBER OF HOLDER, FOR EXAMPLE COMPANY NUMBER, CHARITY NUMBER (WHERE APPLICABLE)

NAME, ADDRESS AND TELEPHONE NUMBER OF DESIGNATED PREMISES SUPERVISOR WHERE THE PREMISES LICENCE AUTHORISES THE SUPPLY OF ALCOHOL

Mr Taha Ali Said
16 St Wilfrids Crescent, Bradford, BD7 2LQ

PERSONAL LICENCE NUMBER AND ISSUING AUTHORITY OF PERSONAL LICENCE HELD BY DESIGNATED PREMISES SUPERVISOR WHERE THE PREMISES LICENCE AUTHORISES FOR THE SUPPLY OF ALCOHOL

Licence Number: 218452

Issued By: Bradford

ANNEXES

Annex 1 – Mandatory Conditions

REQUIREMENT FOR A DESIGNATED PREMISES SUPERVISOR

No supply of alcohol may be made under the premises licence:

- (a) at a time when there is no designated premises supervisor in respect of the premises licence, or
- (b) at a time when the designated premises supervisor does not hold a personal licence or his personal licence is suspended.

AUTHORISATION OF PERSONAL LICENCE HOLDER

Every supply of alcohol under the premises licence must be made or authorised by a person who holds a personal licence.

AGE VERIFICATION

The premises licence holder or club premises certificate holder must ensure that an age verification policy is adopted in respect of the premises in relation to the sale or supply of alcohol.

The designated premises supervisor in relation to the premises licence must ensure that the supply of alcohol at the premises is carried on in accordance with the age verification policy.

The policy must require individuals who appear to the responsible person to be under 18 years of age (or such older age as may be specified in the policy) to produce on request, before being served alcohol, identification bearing their photograph, date of birth and either –

- a) a holographic mark, or
- b) an ultraviolet feature.

DUTY & TAX

A relevant person shall ensure that no alcohol is sold or supplied for consumption on or off the premises for a price which is less than the permitted price.

For the purposes of the condition set out in paragraph 1:

(a) 'duty' is to be construed in accordance with the Alcoholic Liquor Duties Act 1979,

(b) 'permitted price' is the price found by applying the formula 'P' equals 'D' plus ('D' times 'V'), where-

(i) P is the permitted price,

(ii) D is the amount of duty chargeable in relation to the alcohol as if the duty were charged on the date of the sale or supply of the alcohol, and

(iii) V is the rate of value added tax chargeable in relation to the alcohol as if the value added tax were charged on the date of the sale or supply of the alcohol,

(c) 'relevant person' means, in relation to premises in respect of which there is in force a premises licence-

(i) the holder of the premises licence,

(ii) the designated premises supervisor (if any) in respect of such a licence, or

(iii) the personal licence holder who makes or authorises a supply of alcohol under such a licence,

(d) 'relevant person' means, in relation to premises in respect of which there is in force a club premises certificate, any member or officer of the club present on the premises in a capacity which enables the member or officer to prevent the supply in question, and

(e) 'value added tax' means value added tax charged in accordance with the Value Added Tax Act 1994.

Where the permitted price given by Paragraph (b) of paragraph 2 would (apart from this paragraph) not be a whole number of pennies, the price given by that sub-paragraph shall be taken to be the price actually given by that sub-paragraph rounded up to the nearest penny.

Sub-paragraph (2) applies where the permitted price given by Paragraph (b) of paragraph 2 on a day ('the first day') would be different from the permitted price on the next day ('the second day') as a result of a change to the rate of duty or value added tax.

The permitted price which would apply on the first day applies to sales or supplies of alcohol which take place before the expiry of the period of 14 days beginning on the second day.

Annex 2 – Conditions Consistent with Operating Schedule

All Four Licensing Objectives

None.

The Prevention Of Crime And Disorder

1. The premises shall install and maintain a comprehensive digital colour CCTV system. All public areas of the licensed premises, including all public entry and exit points. The CCTV cameras shall continually record whilst the premises are open to the public and recording shall be kept available and unedited for a minimum of 28 days with the date and time stamping. A staff member who is conversant with the operation of the CCTV system shall be present on the premises at all times when they are open to the public and must be able to produce / download / burn CCTV images upon request by a police officer or an authorised officer of the licensing authority. Any footage must be in a format so it can be played back on a standard personal computer or standard DVD player. Where the recording is on a removable medium (i.e. compact disc, flash card etc.), a secure storage system to store those recording mediums shall be provided.

2. An incident log (which may be electronically recorded) shall be kept at the premises for at least six months, and made available on request to the Police or an authorised officer of the licensing authority, which will record

the following incidents including pertinent details:

- (a) all crimes reported to the venue, or by the venue to the Police
- (b) all ejections of patrons
- (c) any incidents of disorder
- (d) any faults in the CCTV system
- (e) any visit by a relevant authority or emergency service

3. The Designated Premises Supervisor shall ensure that a written notice of authority is kept at the premises for all staff who sell alcohol. The notice shall be made available for inspection upon request of the police or an authorised officer of the licensing authority and all staff selling alcohol must be in possession of formal identification to enable to verify their identity against the notice.

Public Safety

None.

The Prevention Of Public Nuisance

4. Notices will be displayed to ask customers to respect the neighbours and leave quietly. Internal notices will be displayed to ask customers not to gather outside the premise after 10pm at night.

5. The premises licence holder shall ensure that the external areas of the premises are kept clear of litter and refuse.

The Protection Of Children From Harm

6. Legal notices will be displayed to warn minors ID checks are always used when the age of the customer is in doubt. All staff will be trained in challenge 25 procedures. Proof of training will be kept on the premises and updated every 6 months. A record of any incidents will be made and kept on site for inspection.

Annex 3 – Conditions attached after a hearing by the Licensing Authority

7. An appropriate proof of age policy, incorporating the principles of the “Challenge 25” Campaign be implemented; incorporating measures to ensure that any patron wishing to purchase alcohol who may reasonably appear to be under 25 years of age are asked to prove that they are at least 18 years old by displaying evidence of their identity and age in the form of a valid UK passport, new style driving licence displaying their photograph or PASS identification.

8. No licensable activities shall take place at the premises unless or until a CCTV system (with satisfactory internal and external coverage) of a standard acceptable to and to the written satisfaction of West Yorkshire Police and the Licensing Authority has been installed at the premises. The approved CCTV shall be maintained in good working order and used at all times the premises remain open to the public for licensable activities. Any CCTV footage shall be kept for at least 28 days and be available to the Licensing Authority or a Responsible Authority on request.



Licensing Act 2003 - Premises Licence Summary
Licence No: 217668

Date Issued: 31 March 2021

Premises Details

POSTAL ADDRESS OF PREMISES, OR IF NONE, ORDNANCE SURVEY MAP REFERENCE OR DESCRIPTION

24 General Market
489-491 Little Horton Lane, Bradford, BD5 9BY

WHERE THE LICENCE IS TIME LIMITED THE DATES

Not applicable

DATE FIRST GRANTED - ANNUAL FEE DATE

Licensing Act 2003 Fees Regulations 2005

17 December 2020

LICENSABLE ACTIVITIES AUTHORISED BY THE LICENCE

The Supply of Alcohol

THE TIMES THE LICENCE AUTHORISES THE CARRYING OUT OF LICENSABLE ACTIVITIES

The Supply of Alcohol	Mon 07:00-23:00
	Tue 07:00-23:00
	Wed 07:00-23:00
	Thu 07:00-23:00
	Fri 07:00-23:00
	Sat 07:00-23:00
	Sun 07:00-23:00

THE OPENING HOURS OF THE PREMISES

WHERE THE LICENCE AUTHORISES SUPPLY OF ALCOHOL WHETHER THIS IS ON AND/OR OFF SUPPLIES

The Supply of Alcohol Off Premises

NAME AND (REGISTERED) ADDRESS OF HOLDER OF PREMISES LICENCE

Mr Taha Ali Said
489-491 Little Horton Lane, Bradford, BD5 9BY

REGISTERED NUMBER OF HOLDER, FOR EXAMPLE COMPANY NUMBER, CHARITY NUMBER (WHERE APPLICABLE)

NAME OF DESIGNATED PREMISES SUPERVISOR WHERE THE PREMISES LICENCE AUTHORISES THE SUPPLY OF ALCOHOL

Mr Taha Ali Said

WHETHER ACCESS TO THE PREMISES BY CHILDREN IS RESTRICTED OR PROHIBITED

No restrictions.

**Department of Place
Licensing Team**

Mr Taha Ali Said
489-491 Little Horton Lane
Bradford
BD5 9BY

3rd Floor Argus Chambers, Hall Ings
Bradford, West Yorkshire
BD1 1HX

Tel: (01274) 432240
My Ref: LIC217668
Your Ref:
E-Mail: licensing@bradford.gov.uk

Date: 31 March 2021

Dear Sir / Madam

**LICENSING ACT 2003 - PREMISES LICENCE
24 GENERAL MARKET**

I refer to your recent premises licence application under the above Act. I am pleased to advise you that this has now been granted and remains valid unless it is suspended or revoked.

I enclose the Licence, which is in two parts. The holder of the licence must ensure that Part 1, the main Premises Licence (or a certified copy), is kept at the premises under their control or under the control of a nominated responsible person. Part 2, the Summary (or certified copy) must be displayed at a prominent position on the premises.

Please note that under s33 of the Licensing Act a premises licence holder must, as soon as is reasonably practicable, notify the licensing authority of any change of name or address of the holder and must return the premises licence in order that an updated licence can be issued. A designated premises supervisor must also inform the licensing authority of any change of his/her name and address.

Please also note the information enclosed which details both a licence holder and a designated premises supervisor's obligations when ceasing involvement with licensed premises.

An annual charge is payable to the Licensing Authority on the anniversary of the date of grant of the licence, unless an exemption is applicable. I will contact you again in due course if an annual fee is payable.

Yours faithfully

Mrs M McGurk
Senior Licensing Officer

This page is intentionally left blank

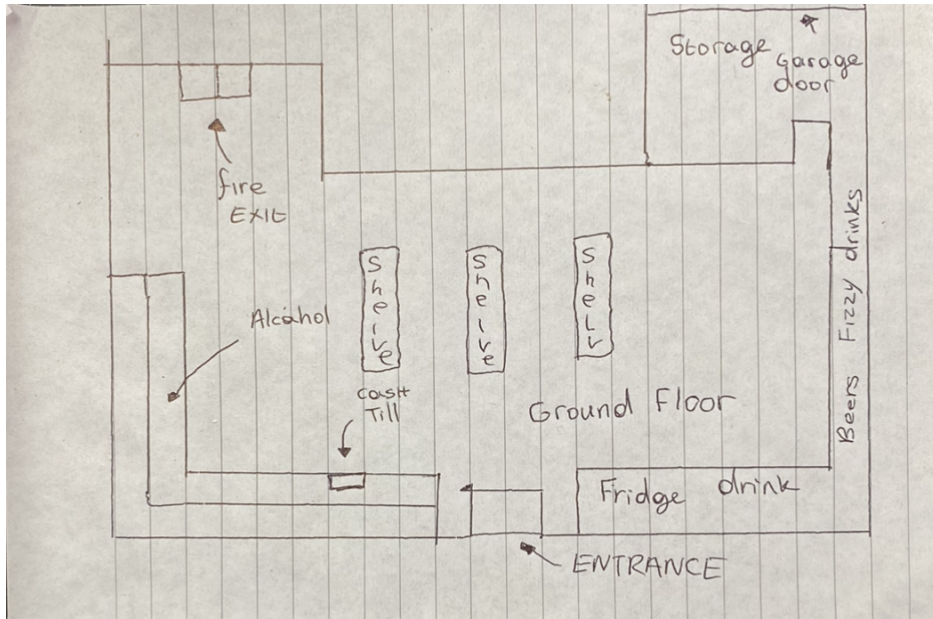

This page is intentionally left blank

Memo

Licensing

3rd Floor
Argus Chambers
Bank Street
Bradford
BD1 1HX

Department of Health and Wellbeing

Environmental Health
5th Floor
Britannia House
Bradford
BD1 1HX

From: Neil Winchcombe

Tel: (01274) 434366
Email: neil.winchcombe@bradford.gov.uk
Date: 5 July 2021

Licensing Act 2003 : Application to vary Premises Licence

24 General Market, 489-491 Little Horton Lane, Bradford, BD5 9BY

Thank you for consulting me on the above application.

The variation seeks to allow the sale of alcohol for 24 hours a day.

This Department has seen an increase in complaints about noise and general disturbance from premises that are open 24 hours a day. These complaints tend to be about noise and disturbance caused by people gathering outside the premises and also about noise from vehicles pulling up outside or near to the premises with their engines running and loud music playing.

The premises are in close proximity to a number of residential properties. The nearest being no's 481, 483 and 485 Little Horton Lane and these are the properties most likely to be affected by any noise and disturbance.

This Department understands that a number of elderly residents have contacted Councillor Talat Sajawal to complain about noise and anti-social behaviour associated with the premises.

In my opinion, the granting of a licence to allow the sale of alcohol 24 hours a day will not benefit the situation and therefore I am minded not to support this application.



This page is intentionally left blank

Appendix 4

From: Cllr Talat Sajawal
Sent: 25 June 2021 14:41
To: Melanie McGurk <melanie.mcgurk@bradford.gov.uk>
Subject: RE: Variation to 489-491 Little Horton Lane

Good afternoon Melanie

I would like to highlight issues that local residents have raised about the shop. There is already a number of young people hanging around and outside the shop. Mainly using a punch machine. There are a number of elderly residents living close by, who have complained of noise and anti-social behaviour. Also the lighting on the front of the shop is too overwhelming to local residents. The fear is, if this variation is successful, the above issues will continue.

I hope these developing issues can be taken into consideration when the panel are making their decision.

Kind regards

Cllr Talat Sajawal
c/o City Hall
Bradford

This page is intentionally left blank

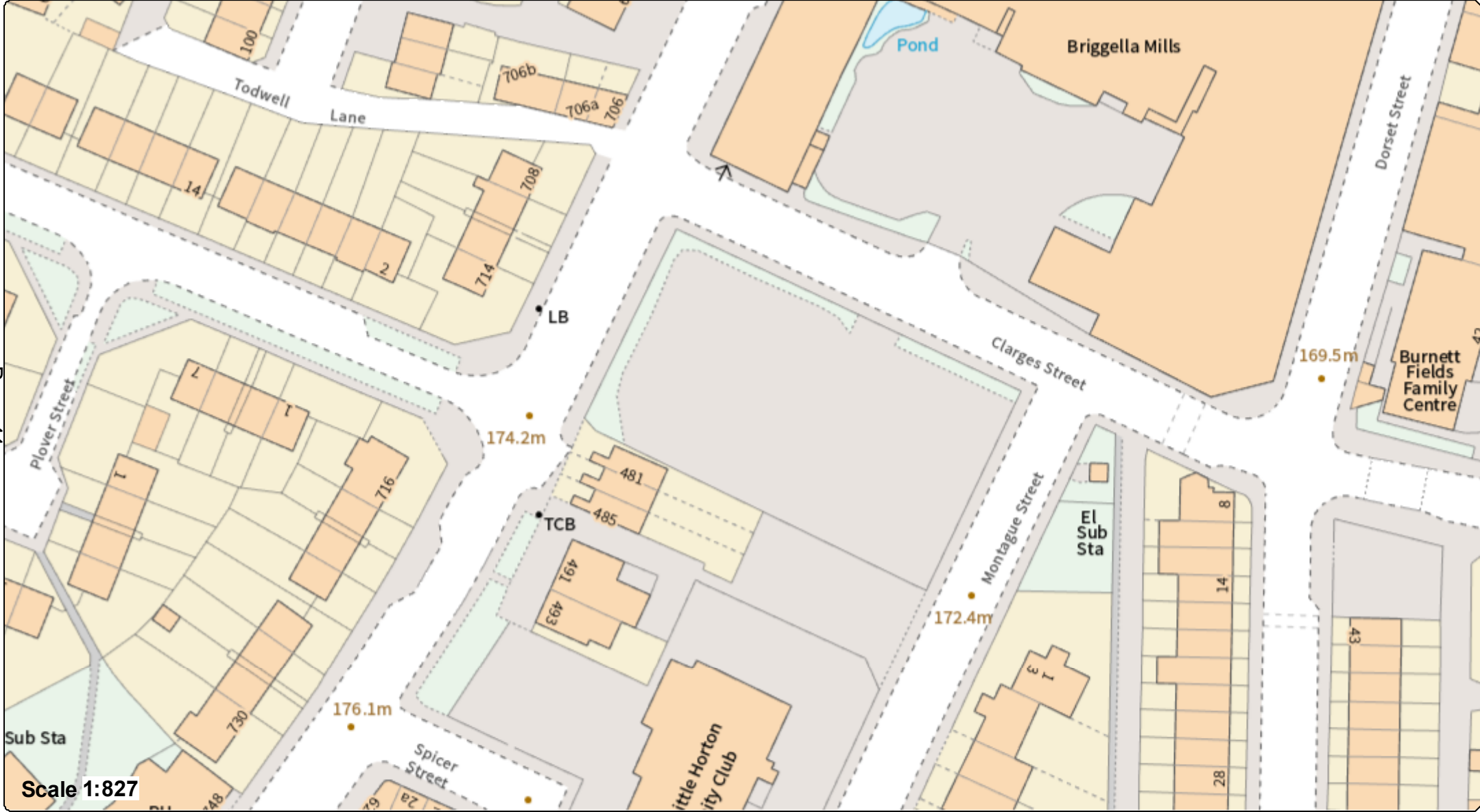

Page 41

This page is intentionally left blank